

STEVCO



SEALS



MECHANICAL SEAL SOLUTIONS

TYPE 5-7

(Similar to Crane type 80)

DESIGN FEATURES & BENEFITS

Mechanical Drive

The Type 5-7 seal is a compact cartridge unit, having a robust positive drive, providing for bi-directional rotation.

Mounting

This seal can be either internally or externally mounted.

Pressure

It can be pressurised either internally or externally to the maximum pressure of 10 bar.

Composition

The 5-7 seal can be easily dismantled for sterilisation.

MATERIAL OPTIONS

Faces:

Rotary- Stainless Steel, Tungsten Carbide and Silicon Carbide

Stationary- Carbon, Tungsten Carbide and Silicon Carbide

Hardware:

316 Stainless Steel

SEAL APPLICATIONS

The Type 5-7 seal was developed to fulfil the requirements of the Food Industry, in both profile and material terms.

The materials of manufacture enable the 5-7 seal to cater for an extensive range of fluid services.

Type 5-7 seals can be used in centrifugal and positive displacement pumps, mixers, votators and other rotating equipment.

OPERATING CONDITIONS

•Pressures:

Type 5-7: To 145psig (10 bar)
1000kPa

•Temperatures:

-30°C to +150°C

(See reverse page for Elastomer Graph)

STEVCO 5-7 SPECIFICATIONS

GA Drawing

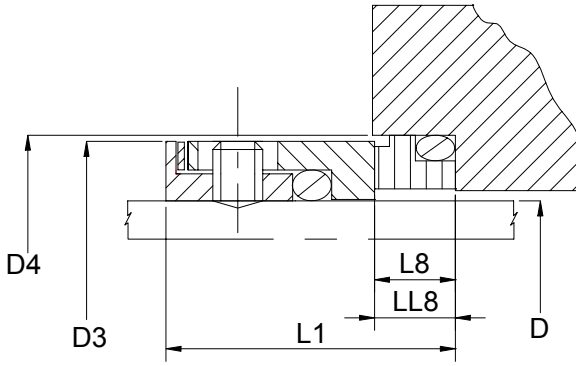

ELASTOMER TEMPERATURE LIMITS

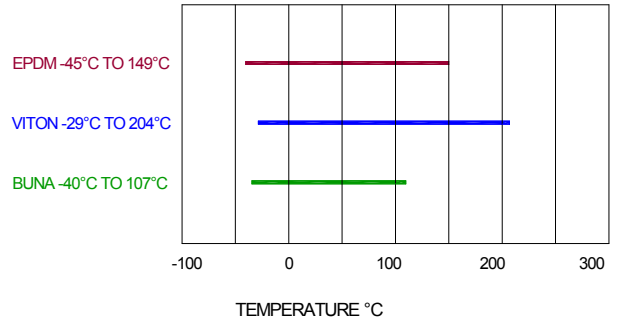

SIZE Metric	SIZE Code	D	D3	D4	L1	L8 (STD)	LL8 (Hard Faced)
16.0	0160	16.00	27.0	28.57	25.4	6.3	6.15
19.0	0190	19.05	30.3	31.75	25.4	6.3	6.15
24.0	0240	24.00	34.2	35.45	26.7	7.6	6.85
28.0	0280	28.00	40.0	42.00	26.7	7.6	6.85
28.5	0285	28.57	40.0	41.27	26.7	7.6	6.85
30.0	0300	30.00	40.7	42.70	26.7	7.6	6.85
31.7	0317	31.75	42.5	44.45	26.7	7.6	6.85
32.0	0320	32.00	42.5	44.45	26.7	7.6	6.85
35.0	0350	35.00	45.6	47.62	26.7	7.6	6.85
38.0	0380	38.00	52.0	53.97	29.2	8.1	8.1
44.4	0444	44.45	58.3	60.32	29.2	8.1	8.1
47.6	0476	47.62	61.5	63.50	29.2	8.1	8.1
50.0	0500	50.00	62.0	63.96	29.2	8.1	8.1
50.8	0508	50.8	64.7	66.67	31.7	9.6	9.6
53.9	0539	53.97	71.0	73.02	31.7	9.6	8.8
54.0	0540	54.00	71.0	73.95	31.7	9.6	8.8
55.0	0550	55.00	73.0	75.00	31.7	9.6	8.8
63.0	0630	63.00	83.7	86.95	34.9	9.1	7.8
63.5	0635	63.50	85.0	88.90	34.9	9.1	7.8
69.8	0698	69.85	89.0	95.25	34.9	9.1	7.8
73.0	0730	73.03	94.8	98.43	34.9	9.1	7.8
76.2	0762	76.20	97.0	101.60	34.9	9.1	7.8
100.0	1000	100.00	124.0	130.00	34.9	9.1	7.8
150.0	1500	150.00	171.5	175.35	34.9	9.1	7.8

PV LIMITS

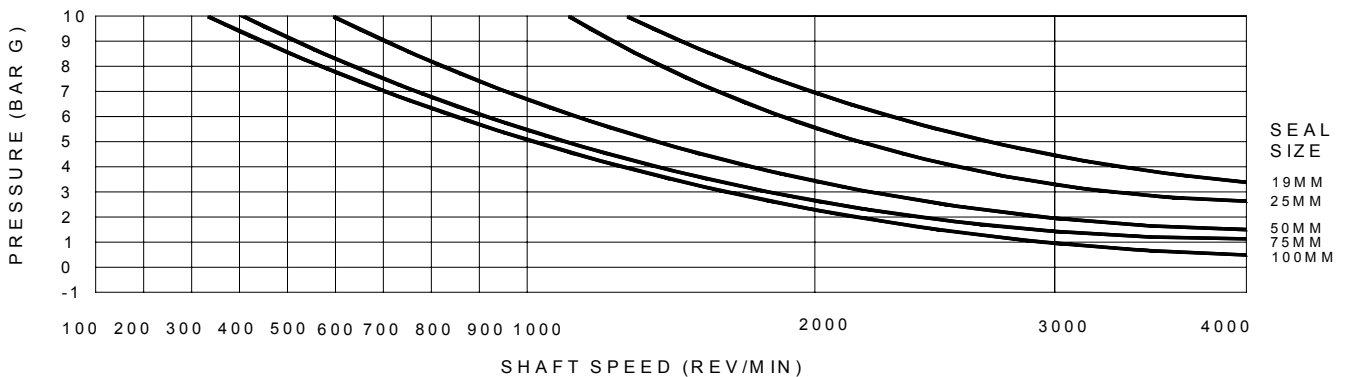

*GRAPH SHOWS THE RELATIONSHIP BETWEEN PRESSURE AND SHAFT SPEED FOR STANDARD FACE AND SEAT MATERIALS (STAINLESS STEEL VERSUS CARBON)



STEVCO SEALS AND PUMPS PTY LTD

11 Samantha Place, SMEATON GRANGE NSW 2567 ~ Ph (02) 4629 6500

STEVCO SEALS & PUMPS VICTORIA P/L

U8, 53 Gateway Blvd, EPPING VICTORIA 3076 Ph (03) 9408 3875