

# T55 Cyclam

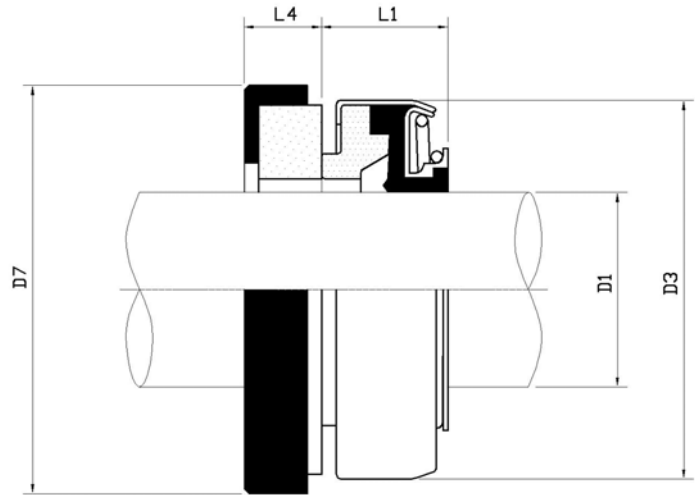

## Design Features

Enclosed rubber bellows seal.  
European designed.  
Main feature is the short working length

## Operating Conditions

**Temperature:** -30°C to +200°C  
(depending on materials used)

**Pressure:** Up to 6 bar, 87psi

**Speed:** Up to 12m/sec,  
2400fpm

## Materials available

carbon/ceramic/nitrile  
sic/sic/viton

## Equivalent to

FA, BO1, T55, CYCLAM seal.

D1	D3	D7	L1	L2	L=L1+L2
6mm	18	22.0	11.0	4.0	15.0
8mm	18	22.0	11.0	4.0	15.0
8mm	18	26.0	11.0	8.0	19.0
10mm	24	26.0	11.0	8.0	19.0
11mm	24	26.0	13.0	8.0	21.0
12mm	24	26.0	13.0	8.0	21.0
12mm	24	25.0	13.0	5.5	18.5
12mm	24	26.0	13.0	5.5	18.5
13mm	24	26.0	13.0	5.5	18.5
13mm	24	26.0	13.0	8.0	21.0
14mm	28	28.5	13.0	8.0	21.0
14mm	28	29.5	13.0	8.0	21.0
14mm	28	25.0	13.0	6.0	19.0
15mm	28	29.5	13.0	8.0	21.0
15mm	32	38.0	13.0	8.0	21.0
16mm	28	29.5	13.0	8.0	21.0
16mm	32	38.0	13.0	8.0	21.0
17mm	39	42.0	13.0	8.0	21.0
18mm	32	32.0	13.0	6.5	19.5
18mm	39	42.0	13.0	8.0	21.0
19mm	39	42.0	13.0	8.0	21.0
20mm	35	35.0	15.5	8.3	23.8
20mm	39	42.0	13.0	8.0	21.0
20mm	42	45.0	13.0	10.0	23.0
22mm	39	42.0	13.0	8.0	21.0
22mm	42	45.0	13.0	10.0	23.0
24mm	47	50.0	13.5	10.0	23.5
25mm	47	50.0	13.5	10.0	23.5
25mm	42	39.3	13.5	8.4	21.9
25mm	42	39.3	13.5	6.0	19.5
28mm	54	57.0	15.0	10.0	25.0
30mm	54	57.0	15.0	10.0	25.0
32mm	54	57.0	15.0	10.0	25.0
35mm	60	63.0	16.0	10.0	26.0
38mm	65	68.0	18.0	12.0	30.0
40mm	65	68.0	18.0	12.0	30.0
45mm	70	73.0	20.0	12.0	32.0
50mm	85	88.0	23.0	15.0	38.0
55mm	85	88.0	23	15	38